

SOCOREX® SELF-REFILLING SYRINGE *ULTRA* 1810

Quick Guide

Body positioning

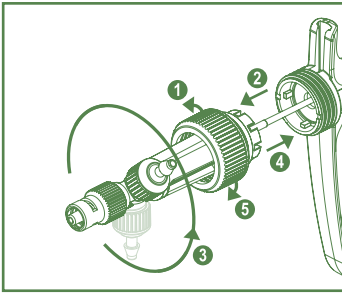

Adjust body position.

Installing tubing

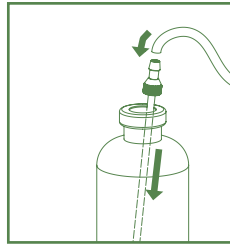

Insert feed needle.
Connect tubing.

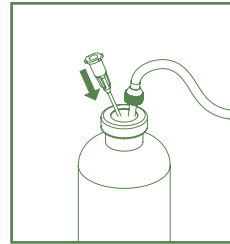

Insert vent cannula.

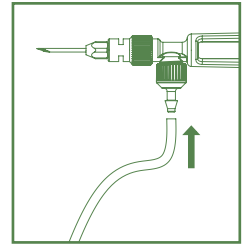

Connect tubing to syringe.

Priming

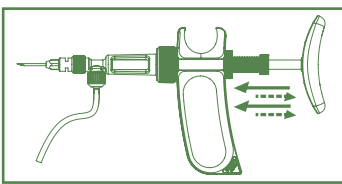

Activate to aspirate and expel liquid.

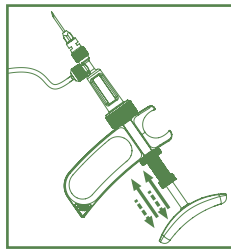

Remove air bubbles.

Volume setting

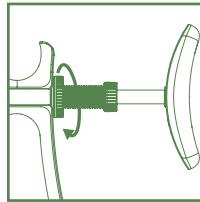

Unlock.

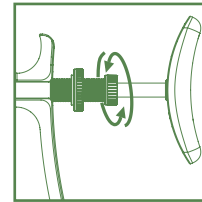

Turn socket to move plunger.

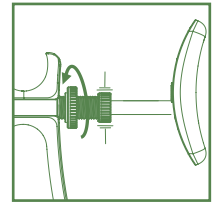

Hold socket and lock.

In case of clogged valve

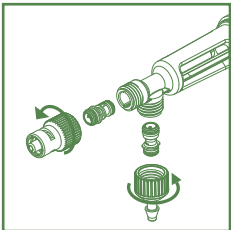

Unscrew and wash valves.
Do not insert any tool
inside valve cartridges.

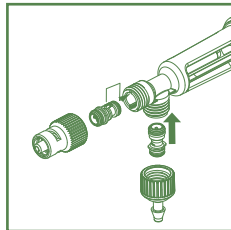

Reassemble according
to mechanical coding.

Volume reading

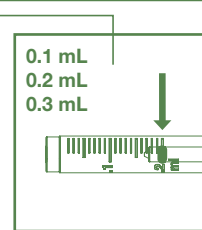
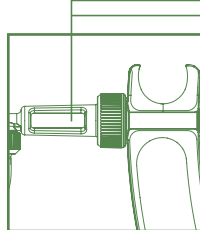

O-ring centered on
graduation.

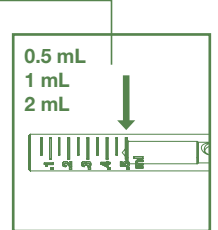

Plunger edge
on graduation.

Purging and rinsing

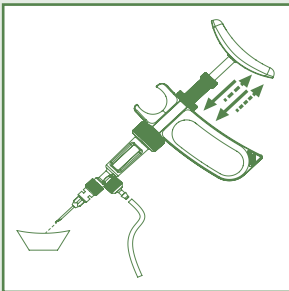

Recover vaccine.
Rinse with water / detergent.

Disassembling and cleaning

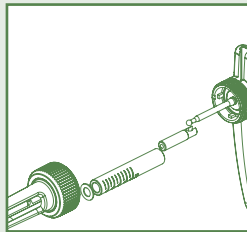

Unscrew nut and separate parts.
Clean and dry parts.



Changing plunger O-ring

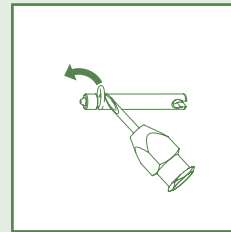

Remove carefully.

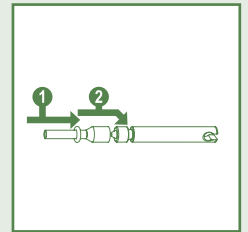

Use guide to roll
new lubricated O-ring
into groove.

Reassembling

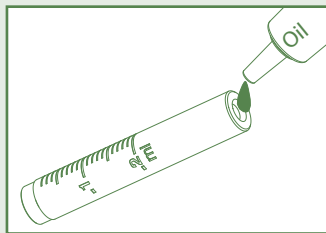

Lubricate barrel entry.

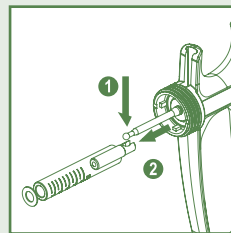

Mount plunger in barrel.
Connect rod.

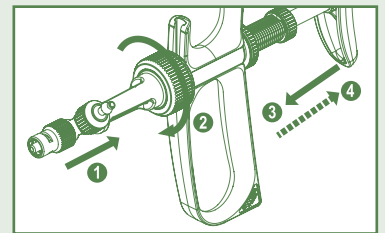

Connect body in pushed position.



I.GUIDE.1810.E - D0223